

8 MOUNTING HOLES  
 ØB.15/8.05 TO SUIT M8 x 1.0  
 MOUNTING STUDS  
 EQUISPACED ON A Ø154.45 P.C.  
 MIN C/BORE Ø17.20

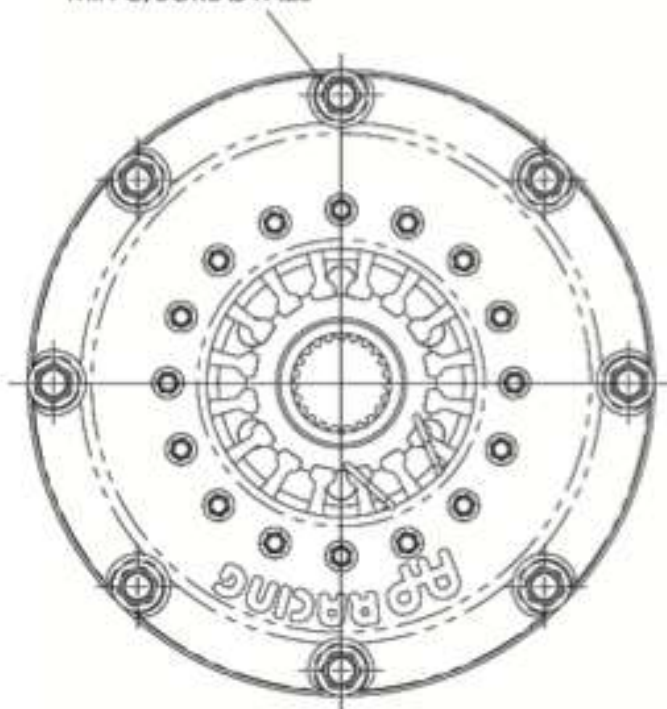

NOTE: EACH HUB VERSION CAN BE  
 USED WITH EITHER FLAT OR STEPPED  
 FLYWHEEL CLUTCHES

HUB ENVELOPE (FROM  
 FLYWHEEL FRICTION FACE)

EXTENDED NOSE HUB

STANDARD HUB

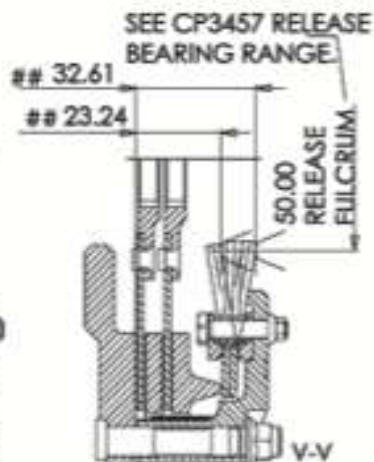
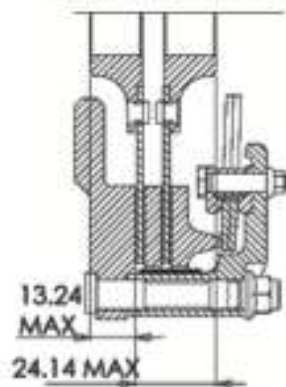

SEE CP3457 RELEASE  
 BEARING RANGE.

RECOMMENDED  
 CLUTCH MOUNTING  
 (FOR ALL TYPES OF  
 ASSEMBLY M8X1.0  
 CP4702 STUD FAMILY  
 AND K-LOCK NUT  
 TIGHTENING TORQUE  
 19Nm [14 lb/ft])  
 LENGTH OF STUD  
 REQUIRED TO BE  
 CALCULATED THUS  
 STUD LENGTH =  
 'C' + 'F' +  
 ('R' OPTIONAL) + NUT.

THE CLUTCH SPIGOT HAS BEEN  
 DESIGNED TO BE THIS DIAMETER  
 WHEN BOLTED TO THE FLYWHEEL  
 BEFORE FITTING (WITH THE  
 INSTALLATION WIRE IN PLACE)  
 THIS DIAMETER MAY BE SLIGHTLY REDUCED

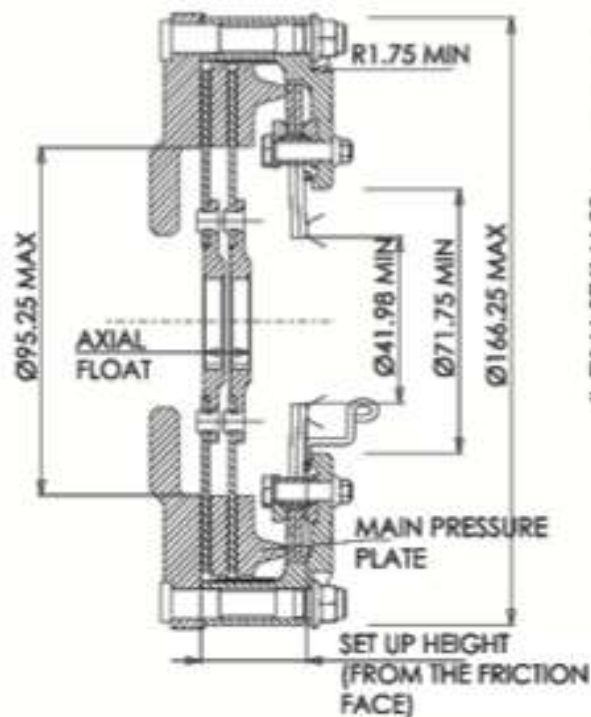

Volant plat

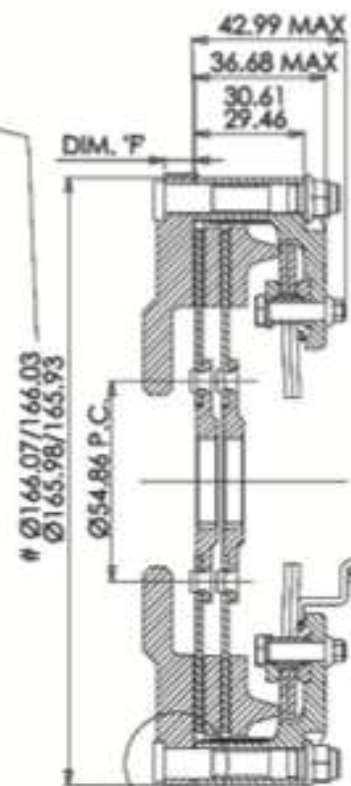

Volant décalé

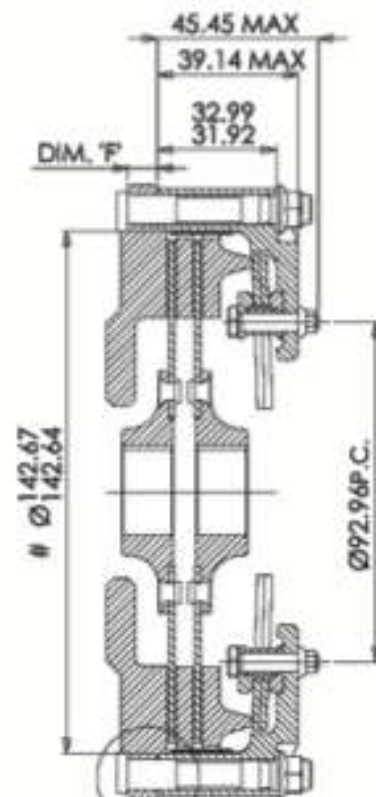

INSTALLATION WIRE FOR  
 USE WHEN INSTALLING A F  
 LAT FLYWHEEL VERSION.  
 TO ENSURE FLYWHEEL SIDE  
 CARBON IS LOCATED ON  
 THE COVER LUGS  
 THIS WIRE MUST BE REMOVED  
 BEFORE USE

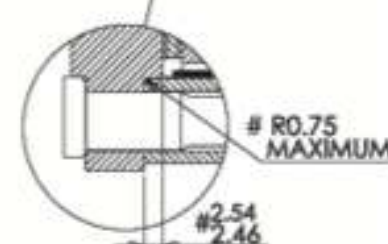
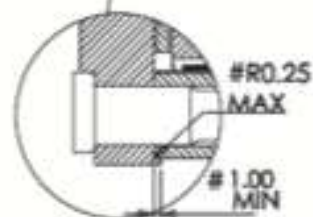

Utilisation générale